



LV JUICE

DON'T SWEAT IT

NZ'S LEADING **LIGHTWEIGHT** WORK GEAR WITHOUT ANY COMPROMISE



**ARC
ARMOUR**

Rating clearly visible

8.7 CAL HRC2

215gsm Woven Lenzing Blend Arc Armour fabric

Inherently Flame Retardant, Antistatic and Arc Flash Protection

Non-conductive zips

Adjustable cuffs & zip gusset

High tensile strength fabric

RANGE INCLUDES

- OVERALL
- JACKET
- CARGO PANTS

Made with LENZING™ FR – a sustainably produced, inherently flame-resistant cellulosic fibre – our Arc Armour PPE clothing range is not only comfortable, functional, and US NFPA 70E compliant, but also a durable and truly eco-friendly option for a variety of industrial applications.

- ▶ **Very lightweight - cool to wear**
- ▶ Premium Grade HRC2/ PPE2
- ▶ Proprietary 215gsm Arc Armour fabric
- ▶ Rugged & durable



This Month

FREE PACK OF FUDGE OR COCONUT ICE

WHILE STOCKS LAST

When you spend over \$300 (+GST) on one invoice this month



www.transnet.co.nz

FREE BINBOX WITH \$50 OF SADDLES THIS MONTH **PAGE 2**

NEW CADWELD CONTROL UNIT **PAGE 4**

ARC RATED WORK GLOVES **PAGE 8**



HALF SADDLE

FULL SADDLE

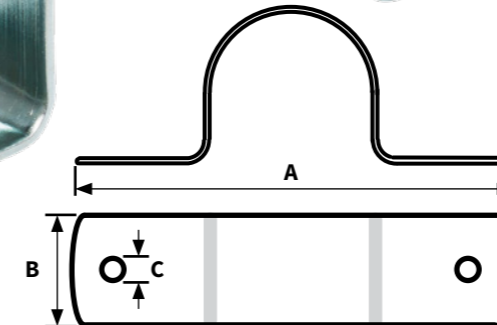
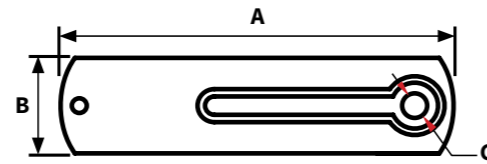
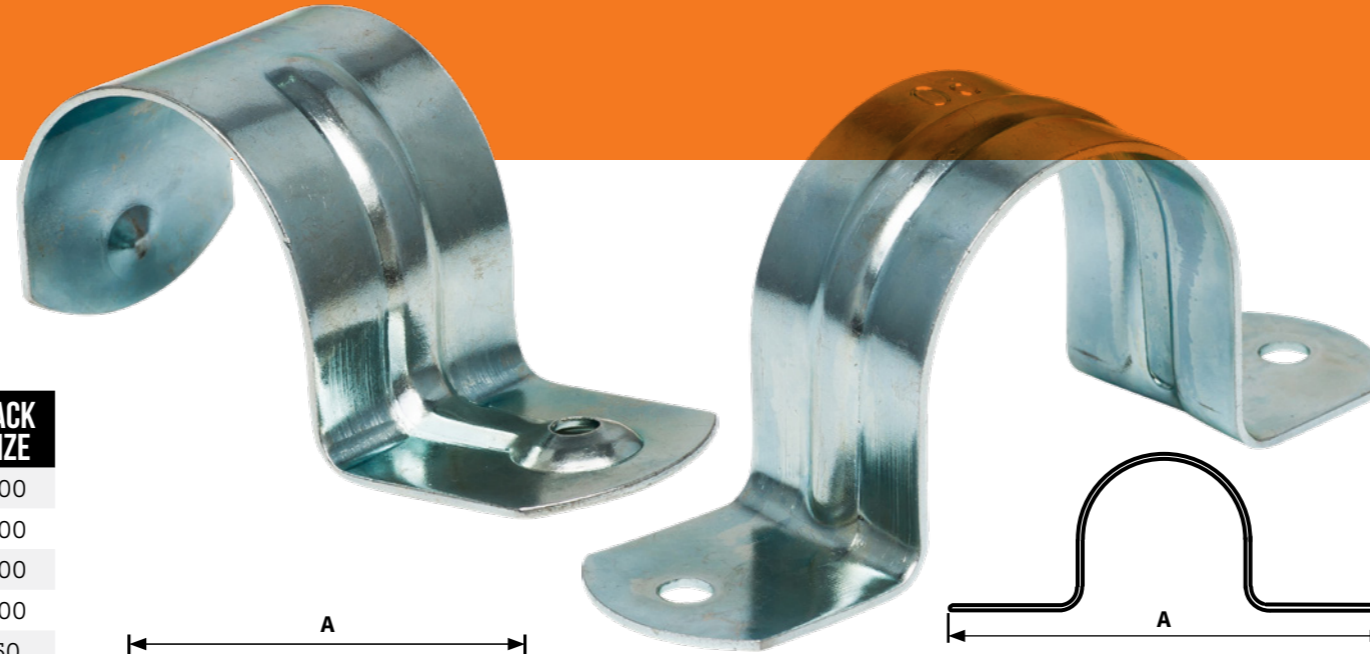

CAT NO.	SIZE (MM)	MATERIAL	LENGTH A (MM)	WIDTH B (MM)	HOLE C Ø	PACK SIZE
TNFS10	10	ZINC COATED	40	13	M5	100
TNFS12	12		40	13	M5	100
TNFS16	16		50	15	M5	100
TNFS20	20		52	15	M5	100
TNFS25	25		63	19	M5	100
TNFS32	32		85	25	M5	100
TNFS40	40	97	25	M5	50	
TNFS16SS	16	304 STAINLESS	50	15	M5	100
TNFS20SS	20		52	15	M5	100
TNFS25SS	25		63	19	M5	100
TNFS32SS	32		85	25	M5	100
TNFS40SS	40		97	25	M5	50
TNFS50SS	50		121	32	M6	50
TSM16MM	16	316 STAINLESS	50	15	M5	100
TSM20MM	20		52	15	M5	100
TSM25MM	25		63	19	M5	100
TSM32MM	32		85	25	M5	100

CAT NO.	SIZE (MM)	MATERIAL	LENGTH A (MM)	WIDTH B (MM)	HOLE C Ø	PACK SIZE
TNHS16	16	ZINC COATED	47	19	M5	100
TNHS20	20		51	19	M5	100
TNHS25	25		62	26	M5	100
TNHS32	32		70	26	M6	100
TNHS40	40		82	32	M6	50
TNHS50	50		94	39	M6	50
TNHS16SS	16	304 STAINLESS	47	19	M5	100
TNHS20SS	20		51	19	M5	100
TNHS25SS	25		62	26	M5	100
TNHS32SS	32		70	26	M6	100
TNHS40SS	40		82	32	M6	50
TNHS50SS	50		94	39	M6	50

FEATURES

- Available in 304 Stainless Steel or Zinc coating
- Multiple sizes
- Mounting hole on one side

FEATURES

- Available in 316 Stainless Steel, 304 Stainless Steel, or Zinc coated material
- Multiple sizes
- Mounting holes on two sides

TRANSNET BINBOX

FREE WITH EVERY \$50+GST OF SADDLES THIS MONTH*



*On one invoice, while stocks last



INDEPENDENTLY TESTED IN NZ

Each of our metalware products has been independently batch tested in New Zealand by skilled technicians to ensure that the highest quality standards are maintained. Our comprehensive metalware range is designed to perform successfully in our local environment. Robust, precise, and dependable, TransNet metalware works whenever and wherever you need it.



Test Reports Available



TRANSNET MONTHLY GIVEAWAY SUPPORTING KIWI BUSINESSES

Have we got a sweet treat for you! Mary Gray Confections has been handcrafting sweets in Christchurch for more than 70 years. This innovative Kiwi company is consistently creating and adding new products to their offering. To ensure they retain that authentic homemade taste, Mary Gray has adopted a commercial style homemade system

incorporating technology such as digital thermometers, automatic mixers, and high-pressure gas burners with very large pots! But the heart and soul of maintaining the homemade taste is the staff who pride themselves on achieving perfection with every batch.

Enjoy your sweet treat!

www.marygray.co.nz



CADWELD PLUS IMPULSE EXOTHERMIC WELDING CONTROL UNIT



**NEW
PRODUCT**

Our latest innovation, the nVent ERICO Cadweld Plus Impulse Exothermic Welding Control Unit, brings you the highest level of flexibility and ease of use of any of our ignition systems. Precision engineered, the control unit lets you choose your power source: from off-the-shelf AA-batteries to the rechargeable Lithium-Ion packs you have on your job site.

Why should you choose our latest ignition system? Safety, power and ease-of-use.

SAFETY

- Self-closing trigger guard prevents accidental ignition, providing added safety
- LED ignition counter provides instant feedback on the timing of the ignition and is visible in sunny outdoor conditions
- Five second delay in ignition is a safety feature to allow the user to stop ignition, if necessary

POWER

- Battery life indicator integrated into the unit for real-time updates on battery life; compatible with both AA and rechargeable batteries

- Includes AA alkaline batteries to power approximately 600 connections
- Rechargeable batteries from Milwaukee® or DEWALT® can be used to power approximately 1500 connections using a 4Ah battery
- Battery adapters available for use with either Milwaukee® or DEWALT® rechargeable batteries (sold separately)

EASE-OF-USE

- High temperature lead with single molded insert into the control unit keeps the most-often replaced component of ignition systems more securely attached and reliable
- Easy-to-use alligator clip design of the termination clearly shows a positive connection in the viewing window
- Enhanced power tool style grip is ergonomic and easy to hold

CAT NO.	DESCRIPTION
PLUSCU2L6	UNIT WITH 1.8M LEAD
PLUSCU2RLD6	REPLACEMENT 1.8M LEAD
PLUSCU2BM	MILWAUKEE ADAPTER
PLUSCU2BD	DEWALT ADAPTER



Battery unit flexibility with included AA batteries and optional tool battery adapters for Milwaukee® 18V and DEWALT® 20V batteries

Durable, heat resistant cable and clip connector with circular viewing window to visually confirm a proper connection between the control unit and nVent Cadweld Plus cup.





TRUST RAYCHEM TECHNOLOGY TO KEEP WORKING EVEN WHEN YOU AREN'T

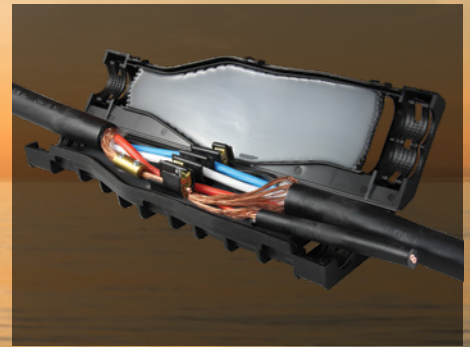
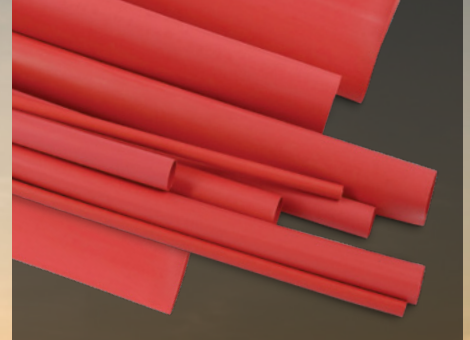

Leaders in cross-linking technology, the Raychem product line provides high levels of service, quality, and decades of experience, with products that continue to perform in the field for 40 years and counting. Our customers appreciate knowing that the products they install will work even in the harshest environments New Zealand has to offer.

AVAILABLE FROM ALL GOOD ELECTRICAL WHOLESALERS

©2016 TE Connectivity TE connectivity (logo) and EVERY CONNECTION COUNTS are trademarks.

EVERY CONNECTION COUNTS



Ph 0800 442 182
+64 9 274 3340

sales@transnet.co.nz

www.transnet.co.nz



LEDIL58

LED INDUSTRIAL & COMMERCIAL HIGH BAY

The LEDIL58-150AC-MS is a glass free high bay that delivers exceptional performance with a high lumen output using 140lm/W Luxeon LED driven by Mean Well 1-10V driver.

This high bay has inbuilt light and microwave motion sensor located in the centre of the IP66 fitting that is easily adjusted using a remote control (product code: LEDIL58-REMOTE).

The preset/default settings of the sensor should suit most workshop, warehouse and production area requirements.

TECHNICAL SPECIFICATIONS

CAT NO.	LEDIL58-150AC-MS
POWER CONSUMPTION	150W
FIXTURE LUMENS	21,000lm
LED LIGHTING EFFICIENCY	140lm/W
COLOUR TEMPERATURE	CW: 5700K
COLOUR RENDERING (RA)	>80
BEAM ANGLE	120°
DRIVER	Mean Well HLG-150H-48B
IP RATING	IP66
CALCULATED L70/B10	>62,000 hours
LED ARRAY	Luxeon 30/30
IMPACT RESISTANCE	IK10
AMBIENT TEMPERATURE	-40°C to +40°C
POWER FACTOR	0.95
BODY WEIGHT	5.9kg
SIZE (MM)	447mm diameter, 125mm height
INPUT VOLTAGE	90-305V AC
MATERIAL	Magnesium alloy housing, PMMA lens
COATING	Anti-corrosion powder-coat
CABLES	White 3 Core flex, 2m length terminated with NZ plug for easy plug & play



10-15m high altitude



Remote control setting



Stand-by dimming level



On/off control



Detection area



Hold-time



Daylight sensor



Stand-by period



FLUKE-1662

Multifunction Installation Tester

The Fluke 1662 gives you reliability, simple operation, & all the testing power you need for basic installation testing.

Key Features

- Voltage TRMS (AC & DC) & frequency
- Wiring polarity checker, detects broken PE and N wires
- Insulation resistance
- Continuity and resistance
- Continuity test (@ 10 mA)
- Loop and line resistance
- Prospective Earth Fault Current & Prospective Short-Circuit Current
- RCD trip time & trip current (ramp test)
- Measures trip time and current for RCD type A and AC in one test
- RCD variable test current
- Automatic RCD test sequence
- Phase sequence test
- On/Off switchable Auto Start for RCD and Loop test
- Self-test
- Illuminated display
- Memory
- Hard case
- Remote control probe
- Zero adaptor



\$1875.00 + GST



TransNet honours
Fluke warranties

FLUKE®



MD9880

TRMS Multimeter with Thermal Imaging Camera

The MD9880 combines essential multimeter functions with thermal viewer, allowing you to quickly locate a wide array of possible faults.

Key Features

- Thermal view
- Automatic and manual range
- Hold and auto-hold modes
- MIN/MAX values capture
- Relative mode
- Peak capture mode
- Rechargeable 3.7V 1400mA lithium ion battery with 6 hours typical battery life
- CAT III 300V
- IR resolution 80 x 80 pixels
- Display resolution 240x320 pixels
- Temperature range -20°C to +260°C

Measurement Functions

- Temperature with cursor on camera
- TRMS DC and AC voltage & current
- Resistance
- Frequency
- Capacitance
- Duty cycle
- Diode test

Applications

- Troubleshooting electrical installations, electrical equipment, electric vehicles
- Mid-level electrical testing
- Field service
- Building and facility maintenance
- Energy loss analysis

\$1059.00 + GST

FITS LIKE A GLOVE

13/4HFR Arc Rated Work Gloves



Auckland

78 Cryers Road
East Tamaki
Auckland
NEW ZEALAND
Ph 0800 442 182
Fax 0800 442 183
PO Box 39 383
Howick, Auckland

Wellington

10 Petone Ave
Petone
Wellington
NEW ZEALAND
Ph 04 576 2530
Fax 04 576 0040
PO Box 39 383
Howick, Auckland
NEW ZEALAND
sales@transnet.co.nz

TransNet Tonga

Nuku'alofa

Lakalakaimonu Multi Utility
Complex
Taufa'ahau Road
Poutaha
Nuku'alofa
TONGA
Ph +67 627 939
Fax +67 627 976
PO Box 2932
Nuku'alofa
TONGA
transnet@kalianet.to

FEATURES

- Flame resistant
- Optimized for medium Arc Flash risks
- Improved Dexterity
- Perfect in tough working conditions with high spark, heat and flame risks
- High performance in cut resistance
- Cat II
- Arc Flash ASTM F2675, ATPV = 30 cal/cm² palm, 5.8 Cal/cm² back of hand

Cat No.	Description
13-4HFR	FLAME RESISTANT ARC FLASH GLOVES

Use suffix for size: -XS, -S, -M, -L, -XL, -2XL

ARC FLASH

ASTM F2675, ATPV=
30 Cal/cm² (Palm)
5.8 Cal/cm² (Back of Hand)

EN388



3543E

EN407



41324X

ASTM F2675



5.8-30



ANSI CUT LEVEL
A5



FREE

Bottle of Clinell Hand Sanitising Liquid CFA60 when you buy a pair of 13-4HFR gloves this month*



***While stocks last**

TransNet NZ Ltd has made every reasonable effort to ensure the accuracy of this information and it is to the best of our knowledge correct and reliable. Under no circumstances does this constitute an assurance of any particular quality or performance and users should independently evaluate the suitability of products for their desired application. All information in this publication including pricing, drawings, illustrations, images and graphic designs are reflections of our current understanding. TransNet NZ Ltd reserves the right to make any adjustment to this information at any time. Our liability for the products outlined in this publication is set forth in our standard terms and conditions of trade. In case of any potential ambiguities or questions, please contact us for clarification.



NEW ZEALAND OWNED